

**Rotary**  
Fairbanks



**Rotary**  
Pathway Playground

# PATHWAY PLAYGROUND

**Tanana Lakes Recreation Area**

# TANANA LAKES Recreation Area

4400 S Cushman St Exd  
Fairbanks, AK 99701  
<http://parks.fnsb.us>

**TANANA LAKES OFFICE**  
(907) 459-1115

**PARKS & REC OFFICE**  
(907) 459-1070



The Tanana Lakes Recreational Area is a project of the Fairbanks North Star Borough. Land once used to dump old car bodies (and some human ones) and to host various kinds of illicit activity, has been transformed into a family-friendly recreational center. The location is adjacent to what was once considered a depressed area of the community. Development is ongoing, and the community has already begun to embrace the site's many opportunities for fun and recreation.

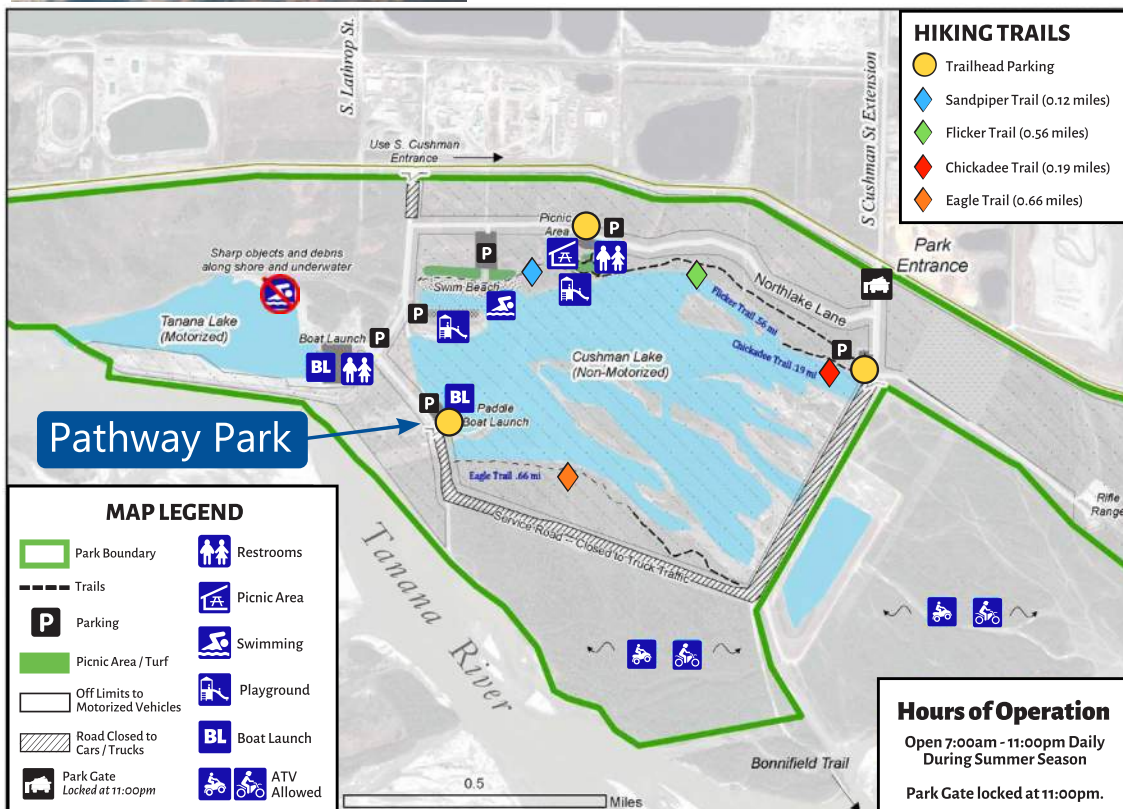



# BACKGROUND & CONCEPT

The Rotary Club of Fairbanks recognized early on the value of this recreational area to the community. Our local municipality, FNSB, is not able to fund all of the desired activities on the huge tract. Past, current and future presidents of Rotary Club of Fairbanks decided to pool their efforts over a multi-year span in order to install a unique playground for kids. Traditionally the club president selects a "major" project for that president's one-year term. Funding averages around \$10,000 per year, raised through a variety of methods, including the annual Chena River Run 5-K Race. This is the largest project ever tackled by the Club.

Below is a schematic of the peninsula on which the Pathway Playground is located. Note that it is across shallow water from the swimming beach shown on the back page.

When the project began, the peninsula was raw ground. This parking lot shown, at the left of this image, was added along with the arch shown on the cover of this booklet.



# DEVELOPMENT PLANS

Three playground elements have been installed at the end of the peninsula as shown in these drawings and on the back page. Three more elements have arrived in Fairbanks to be installed in the Spring of 2021. These are detailed on the following pages. Additional elements and features await funding.

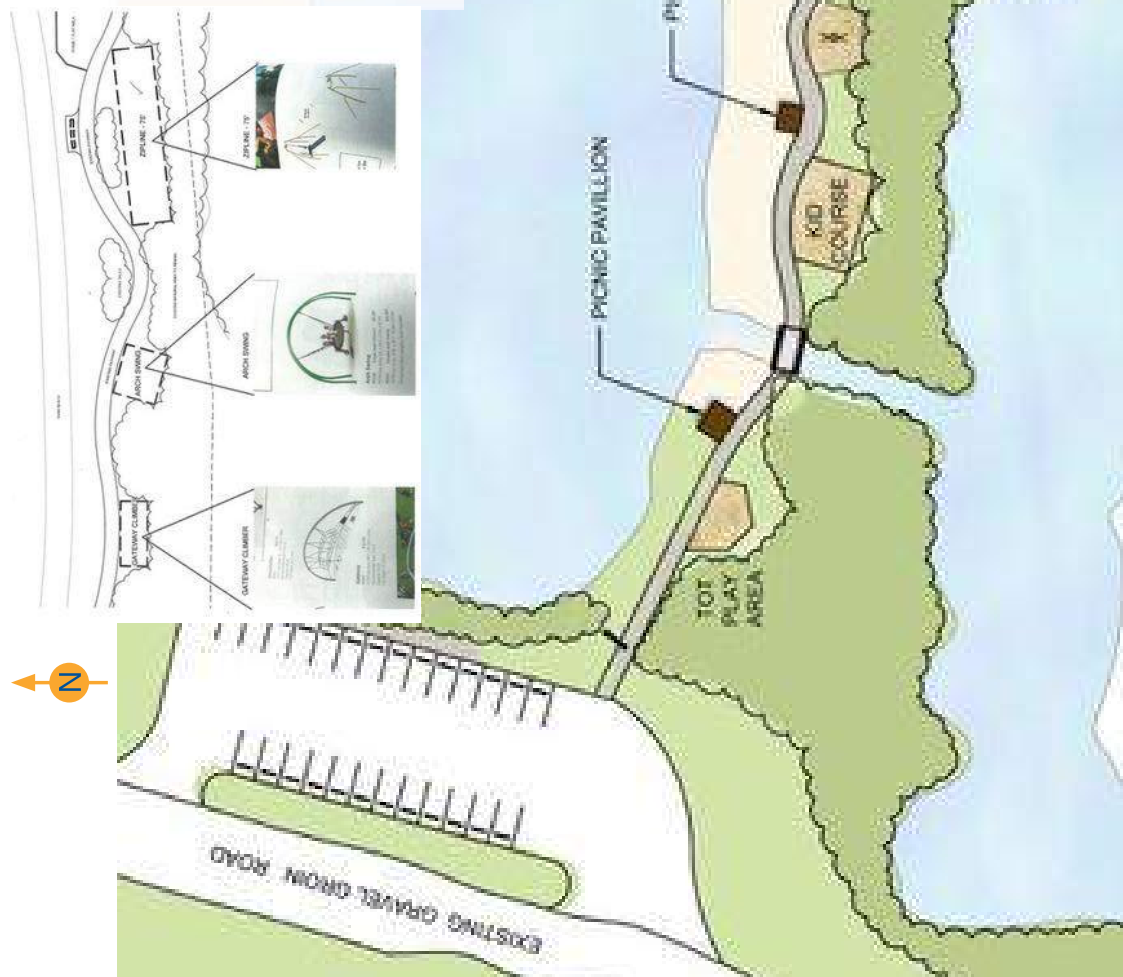

# INSTALLED ELEMENTS

Shown are the current installations. All of the equipment installed and planned is of the best quality with high safety ratings. Installation has been done by professionals.



Overhead Spinner

Tall & Medium Spring Climbers nest the Spinner

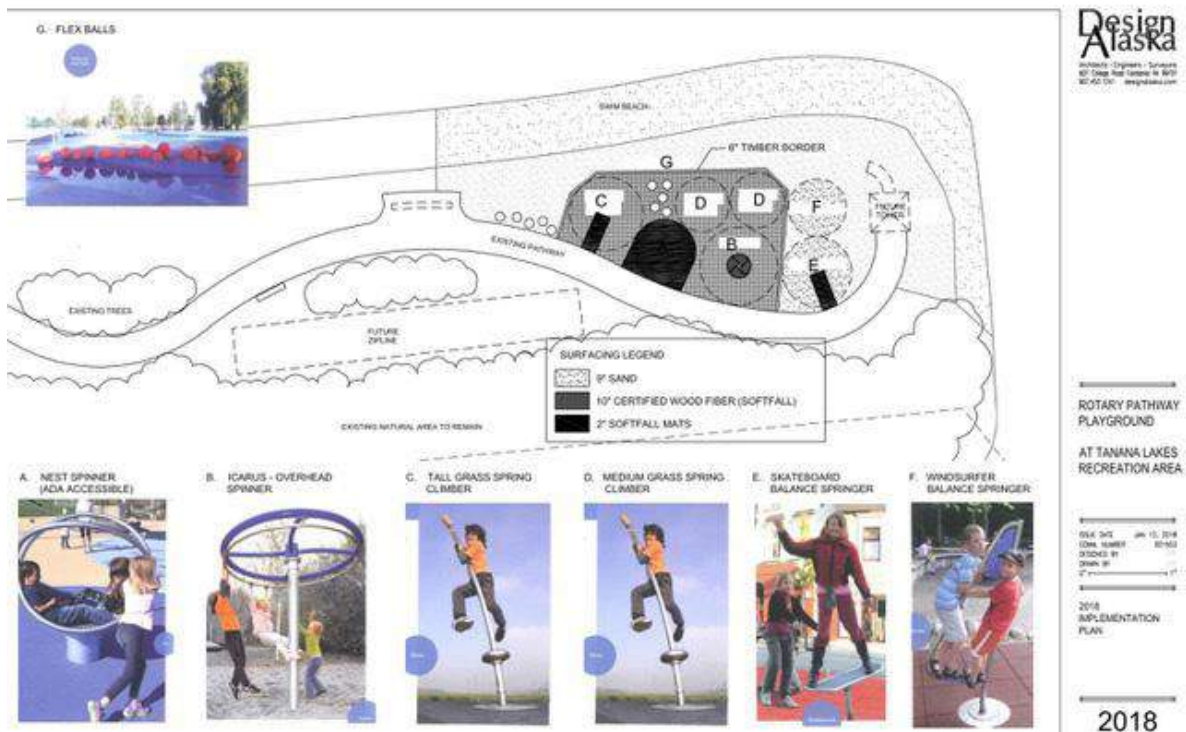

# ELEMENTS AWAITING INSTALLATION

These are the three elements that have arrived in Fairbanks to be installed in the Spring of 2021.



Arch Swing



SkyRun ZipLine - 100'



Gateway Climber





# FINAL PLAYGROUND UNITS

Two pods of additional equipment will be added to extend play opportunities to younger children.

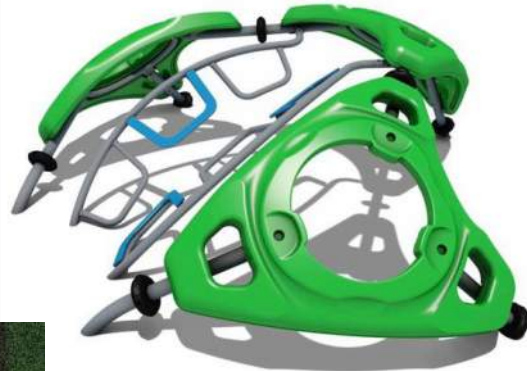



---

---

# FUTURE PLAYGROUND FEATURES

Two Pavillions



Treehouse  
Lookout



Three Benches

These enhancement features will allow parents a place to sit while their kids are playing, give shelter from inclement weather and add yet another climbing/ exploring opportunity.



# PROJECT EXPENSES 2016-2021

Rotary Club of Fairbanks  
Transaction Detail By Account  
January 1, 2014 through February 9, 2021

Type	Date	Num	Name	Memo	Debit	Balance
<b>CONTRIBUTION EXPENSE</b>						
<b>5200 - Major Project - Local</b>						
<b>Pathway Park Project</b>						
Check	01/21/2021	7974	GameTime	Invoice #PJL-0152283	34,315.64	34,315.64
Check	02/02/2021	8052	Span Alaska	Shipping PRO: 3116578 Quote #3048527	11,556.50	45,872.14
Total Pathway Park Project					45,872.14	45,872.14
<b>Rotary Play Park Expense</b>						
Check	08/04/2017	7252	Spennard Builders Su...	Gateway Installation-8 non-treated timbers	1,114.40	1,114.40
Bill	08/31/2017	7971	Great Northwest Inc.	-MULTIPLE-	2,848.47	3,962.87
Bill	09/28/2017	3496	Weber Inc	Excavate & construct pathway in the Tanana Lakes ...	8,750.00	12,712.87
Bill	04/26/2018	GO7567	Goric Marketing Gr...	-MULTIPLE-	36,740.00	49,452.87
Total Rotary Play Park Expense					49,452.87	49,452.87
<b>5200 - Major Project - Local - Other</b>						
Bill	07/20/2016	1074	TJ's Land Clearing Inc	Clearing of brush and tress for parking on the Tanan...	2,610.00	2,610.00
Bill	05/03/2017	50040...	Graphic North	Children Tile Project	212.68	2,822.68
General Journal	06/30/2017	WW ...		Consolidate play park expenses	23,995.87	26,818.55
Bill	08/22/2018		Span Alaska	Shipping of Icarus, nest and grass	1,572.30	28,390.85
Check	10/30/2018	7449	John Rowe.	-MULTIPLE-	2,937.03	31,327.88
Check	11/08/2018	7454	John Rowe.	Ground material for Rotary Park playground	1,218.75	32,546.63
Check	12/18/2018	7466	Trost Construction, ...	Grade and install curbs at Tanana Lakes Playground	10,023.00	42,569.63

Total = \$137,894.64

The above extract from the Rotary Club of Fairbanks financial accounts shows expenditures through the purchase of the three units of equipment to be installed in the summer of 2021. This does not include donations such as the services of the architectural firm, Design Alaska.

## DONATED PROFESSIONAL SERVICES

The value of donated professional design and engineering services by Design Alaska is currently \$22,386.42. This project could not have moved forward without this contribution.

## DONATED CONSTRUCTION SERVICES

The value of donated work, including excavation, parking lot, Gateway Arch and installation of playground equipment is as follows:

Trost Construction	\$11,700.00
GHEMM Company, Inc.	\$3,950.00
Weber, Inc.	\$30,000.00
Total =	\$45,650.00

## COSTS TO COMPLETE THE PLAYGROUND

Qty.	Item	Cost
1	Installation of 3 units	\$24,700.00
4	Benches @ \$2,000 ea.	\$8,000.00
1	Treehouse Structure	\$35,000.00
2	Pavillions @ \$20,000 ea.	\$40,000.00
2	Playground Units	\$35,000.00
	Total =	\$142,700.00

## PROJECTED RESOURCES

Rotary (meals not eaten)	\$18,000.00
Donor Advised Fund	\$22,000.00
Dorothy Sugg Donors	\$10,000.00
Total =	\$50,000.00

During the COVID-19 pandemic the Fairbanks Rotary Club has been meeting virtually. Many club members are donating the cost of luncheon meals not eaten to this project.

The Donor Advised Fund (DAF) is a 501(c)(3) endowment fund created by former club member Dorothy Sugg's gift of her home and estate. This fund has committed its 2020 and 2021 available gifting to this project.

Dorothy Sugg donors contribute \$1,000 to the DAF. Funds donated in 2021 will go toward the park project.

## FINANCIAL SUMMARY

Rotary Funds	\$137,895.00
Donated Services	\$68,036.00
Total =	\$205,931.00

Cost to Complete Park	\$142,700.00
Less Projected Rotary Funds	\$50,000.00
Funds Needed	\$92,700.00



# **DOROTHY SUGG DONOR CONTRIBUTIONS**

The following have each contributed \$1,000 to the Rotary Club of Fairbanks Donor Advised Fund for use in the Pathway Playground Project:

Bell Development (Bert & Becky Bell)

Aisha & Jon Bray

Wayne Clark

Skip & Olga Cook

Betty L. Everts

Gretchen Gordon & Jason Case

Lloyd D. Huskey

Jo A Kuchle & Gene Therriault

Meg Nordale & Bob Schruf

NTL Alaska Inc. (Peggy & Mike Pollen)

Jack & Suzanne Randolph

Taber S. Rehbaum

Douglas Schrage

Barbara Schuhmann

**Thank You!**



Youth at the swimming beach of Tanana Lakes Recreation Area (above). Across from the beach, at Pathway Park (below), children enjoy the already installed playground units.



Published and printed, as a donation to the  
Pathway Playground effort at

